

Soils Map

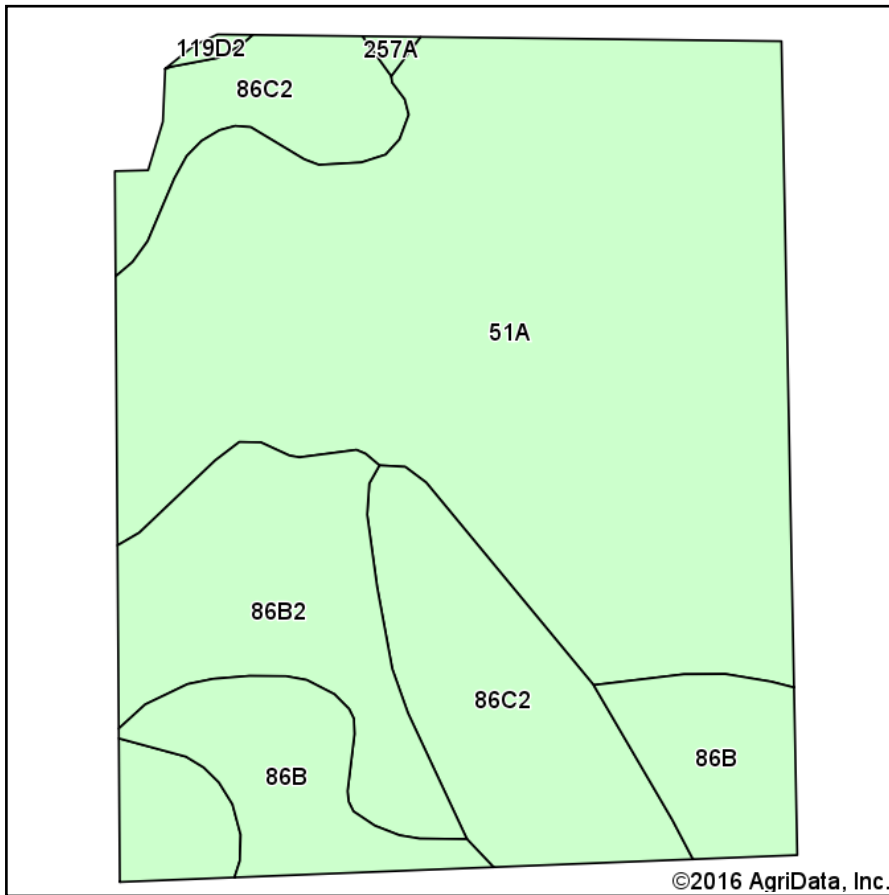

Soils data provided by USDA and NRCS.

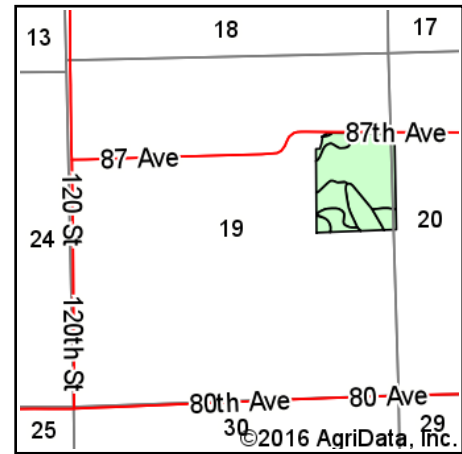

State: **Illinois**
 County: **Warren**
 Location: **19-9N-1W**
 Township: **Berwick**
 Acres: **45.28**
 Date: **10/6/2016**

VAN ADKISSON
 AUCTION SERVICE LLC
 ROSEVILLE, IL 61473 - PH: (309)426-2000
 www.bliddersandbuyers.com
 IL License #440.000120

Maps Provided By:

 CUSTOMIZED ONLINE MAPPING
 © AgriData, Inc. 2016 www.AgridataInc.com



Area Symbol: IL187, Soil Area Version: 9

Code	Soil Description	Acres	Percent of field	Il. State Productivity Index Legend	Corn Bu/A	Soybeans Bu/A	Crop productivity index for optimum management
51A	Muscataune silt loam, 0 to 2 percent slopes	26.81	59.2%		200	64	147
**86C2	Osco silt loam, 5 to 10 percent slopes, eroded	7.63	16.9%		**178	**56	**131
**86B2	Osco silt loam, 2 to 5 percent slopes, eroded	5.56	12.3%		**181	**57	**134
**86B	Osco silt loam, 2 to 5 percent slopes	5.09	11.2%		**189	**59	**140
**119D2	Elco silt loam, 10 to 18 percent slopes, eroded	0.10	0.2%		**134	**44	**100
257A	Clarksdale silt loam, 0 to 2 percent slopes	0.09	0.2%		174	56	128
Weighted Average					192.5	61.2	141.8

Area Symbol: IL187, Soil Area Version: 9

Table: Optimum Crop Productivity Ratings for Illinois Soil by K.R. Olson and J.M. Lang, Office of Research, ACES, University of Illinois at Champaign-Urbana. Version: 1/2/2012 Amended Table S2 B811

Crop yields and productivity indices for optimum management (B811) are maintained at the following NRES web site:
<https://www.ideals.illinois.edu/handle/2142/1027/>

** Indexes adjusted for slope and erosion according to Bulletin 811 Table S3

Soils data provided by USDA and NRCS. Soils data provided by University of Illinois at Champaign-Urbana.

*c: Using Capabilities Class Dominant Condition Aggregation Method